

10mm + 12A + 10mm hoher transpazifischer Isolierglaslieferant, 32mm Isolierglaseinheit, Isolierglas mit Doppelverglasung.

10mm + 12A + 10mm Isolierglas besteht aus 10mm + 10mm zwei Glaseinheiten mit einem durch einen Aluminiumrahmen gefüllten Raum, der mit hochwirksamen Trockenmitteln gefüllt ist. Der Rand des Isolierglases wird durch hochfeste Dichtungsmassen abgedichtet. Isolierglas muss aus zwei Dichtungsmitteln bestehen, die durch einen hohen Butylkautschuk-Dichtstoff auf beiden Seiten Aluminiumrahmen zur Verklebung bringen. Die andere ist der Name Silikondichtungsmasse, mit der Isolierglas aufgemalt wird. So Isolierglas hat ein hohes Haftvermögen und eine hohe Energieeinsparung.

Wie erkennt man das hochwertige Isolierglas?

Ein gut isoliertes Glas wird mit Inertgasen und Trockenmittel in die Glasmitte gefüllt und es sieht aus wie durchsichtig, ohne Nebel. Der Rand des Isolierglases ist dehnbar, und wenn Sie ihn mit dem Finger berühren, kann er nicht herausfallen. Im Gegenteil: Die schlecht isolierten Glasversiegelungen sehen aus wie Nudeln oder Mehl.

Eigenschaften:

1. Energy Saving - Aufgrund der geringen Wärmeleitfähigkeit der Luft zwischen den Gläsern kann das Isolierglas die Wärmeübertragung von innen nach außen verringern. Daher kann Energie um 30-50% gespart werden.
2. Sound Isolationsleistung - eine Schicht Glas kann das Rauschen auf 20-22 dB reduzieren. Normales Isolierglas kann das Rauschen auf 29-31 reduzieren, spezielles Isolierglas auf 45dB.
3. Hochtranspacific - Isolierglas ist mit ausreichend Trockenmittel gefüllt, das Dampf im Innenraum effizient absorbieren oder von außen eindringen kann, um sicherzustellen, dass das Glas im Innenraum absolut trocken ist und nicht taut.

Spezifikation:

Glasname: 10mm + 12A + 10mm klares Isolierglas

Max. Größe: 3300X12000mm Min. Größe: 180X350mm

Dickenbereich 12mm-19mm (Doppelverglasung oder Dreifachverglasung)

Luftraum: 6 mm, 9 mm, 12 mm, 16 mm, 19 mm (1/4 ", 11/32", 1/2 ", 9/16", 19/32 ", 5/8")

Gasfüllung: trockene Luft, Argon

Glaszusammensetzung: transparentes Glas, getöntes Glas, gehärtetes Glas, gebogen gehärtet.

Glasarten: gehärtetes Isolierglas, low-e -Isolierglas, Hohlglas, Isolierglas, Isolierglas, reflektierendes Isolierglas, Isolierglas mit Seidenmotivierung, eisenarmes Isolierglas, low-e -Isolierglas, versiegeltes Isolierglas, Fensterglas, Isolierglas für Vorhang Wand.



Anwendung:

Gebäudevorhangmauer, Wohnfenster, Trennwand usw.

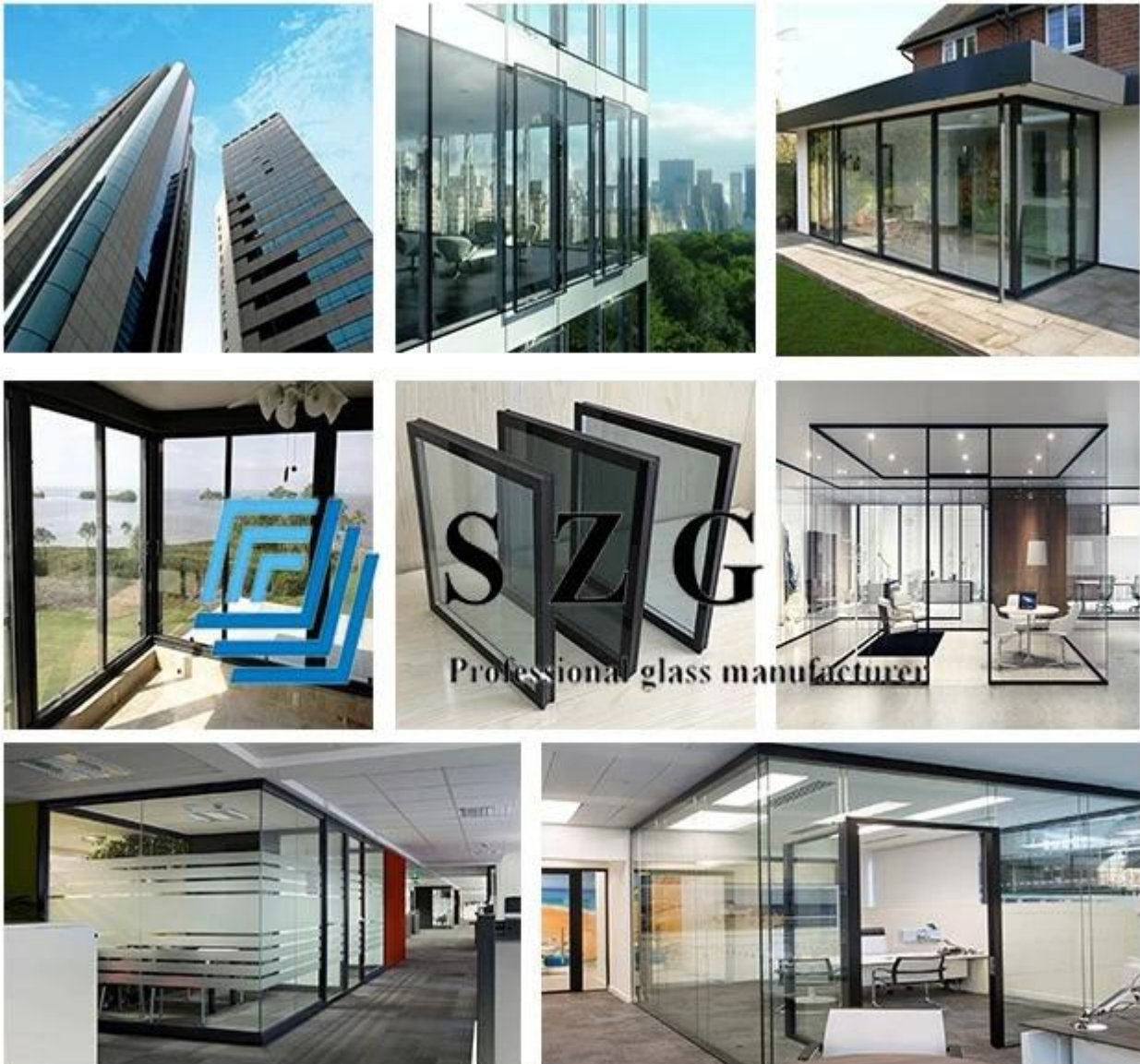

10mm + 12A + 10mm Isolierglas entspricht den Standards von Europa, Nordamerika und China, ISO, CCC, CE, BS6206, EN12510 usw.

Verification of Conformity
 Evaluation of conformity / Product standard
EN 14449:2005
 The mark is subject to the original test report: 401100110002

The product in the certificate: Laminated Safety Glass, manufactured by SHENZHEN SUN GLOBAL GLASS CO., LTD. was submitted to the manufacturer for Performance Testing according to the dimensional / sample specified. The results showed compliance with the applicable requirements. The test results and the content of this certificate of conformity, including those in the table below, are the result of the test results. The results remain valid as long as the certificate and mark in the above mentioned document are not modified significantly.

Company Name:	SHENZHEN SUN GLOBAL GLASS CO., LTD.
Address:	3F, Qiangyuan Building, Shuangyuan Road, Luoyang, Henan, Zhengzhou, Henan, China
Manufacturer Name:	SHENZHEN SUN GLOBAL GLASS CO., LTD.
Address:	3F, Qiangyuan Building, Shuangyuan Road, Luoyang, Henan, Zhengzhou, Henan, China
Product:	Laminated Safety Glass
Model:	Smart Glass, PVB Glass, Smart Glass, PVB Glass, Smart Glass, PVB Glass, Smart Glass, PVB Glass
Trade Mark:	None

Shenzhen, 27 October 2017

DECLARATION OF CONFORMITY

EC Declaration of CPD Conformity

The following product has been tested by Lantest Technology Laboratory Ltd. with the following standards and found in conformity with the CE Council Directive of 89/105/EEC. It is possible to use CE marking to demonstrate the conformity with the CPD Directive.

Report No.: LPTC101202E

Applicant: SHENZHEN SUN GLOBAL GLASS CO., LTD.

Address: NO.34 FLOOR SA RUIJONG BUILDING, BUJIAOYUAN, LONGGANG DISTRICT, SHENZHEN GUANGDONG, CHINA

Manufacturer: SHENZHEN SUN GLOBAL GLASS CO., LTD.

Address: NO.34 FLOOR SA RUIJONG BUILDING, BUJIAOYUAN, LONGGANG DISTRICT, SHENZHEN GUANGDONG, CHINA

Product: Insulated Glass

Model No.: Smart-Glass, Smart-Glass, Smart-Glass, Smart-Glass, Smart-Glass, Smart-Glass

Trade Mark: N/A

Test Standards: EN ISO 1275-8

The relevant test reports show that the product complies with the essential requirements in the above listed standards. The applicant is authorized to use this certificate in connection with the CE Declaration of CPD conformity according to the Directive.

CE Marking

QUALITY MANAGEMENT SYSTEM

CERTIFICATE

Certificate No.: 187104310300005
 No. 187104310300005
Shenzhen Sun Global Glass Co., Ltd
 Certified under the code of Practice number 18045:2015/11/18/19
 Address: Room 3F, Floor 3, Qiangyuan Building, Luoyang, Henan, Zhengzhou, Henan, China
 In scope of the Quality Management System
 The certificate is issued for compliance with the standard
ISO 9001:2015

The Quality Management System applies in the following area:
 Sales of Insulating Glass (IGU) Glass, Tempered Glass, Laminated Glass, Insulated Glass, Mirror Glass and Other Glass Products
 Applicable Clause: 8.5.3

Issue of Issue: New 09, 2016 Date of Validity: 09/09/2018

Nonconformities Audit (The first audit)	Nonconformities Audit (The second audit)	Nonconformities Audit (The third audit)

The quality management system is subject to a yearly surveillance audit within the period of validity of the certificate in valid only when used together with an appropriate Notice of Surveillance Audit issued by TUV.

Issued by: 尹宇晨

Shenzhen Sun Global Glass Co., Ltd

Definet Glass Laminating Solutions

a glass's manufacturer to supply:

SHENZHEN SUN GLOBAL GLASS CO., Ltd

has successfully passed the qualification process of Definet in Nov. 2014

The certificate is valid until the date shown in the below table as long as your manufacturing process for laminated safety glass remains unchanged. Renewal is subject to validation (each supplied laminates)

Date: 2017-05-29

SAFED	SAFED	SAFED	SAFED	SAFED	SAFED	SAFED	SAFED
100%	100%	100%	100%	100%	100%	100%	100%

DECLARATION OF CONFORMITY

Professional glass manufacturer

The following product has been tested by Lantest Technology Laboratory Ltd. with the following standards and found in conformity with the CE Council Directive of 89/105/EEC. It is possible to use CE marking to demonstrate the conformity with the CPD Directive.

Report No.: LPTC101203E

Applicant: SHENZHEN SUN GLOBAL GLASS CO., LTD.

Address: NO.34 FLOOR SA RUIJONG BUILDING, BUJIAOYUAN, LONGGANG DISTRICT, SHENZHEN GUANGDONG, CHINA

Manufacturer: SHENZHEN SUN GLOBAL GLASS CO., LTD.

Address: NO.34 FLOOR SA RUIJONG BUILDING, BUJIAOYUAN, LONGGANG DISTRICT, SHENZHEN GUANGDONG, CHINA

Product: TEMPERED GLASS

Model No.: Smart, Smart, Smart, Smart, Smart, Smart

Trade Mark: N/A

Test Standards: EN 12150-2:2004

The relevant test reports show that the product complies with the essential requirements in the above listed standards. The applicant is authorized to use this certificate in connection with the CE Declaration of CPD conformity according to the Directive.

CE Marking

DECLARATION OF CONFORMITY

Professional glass manufacturer

The following product has been tested by Lantest Technology Laboratory Ltd. with the following standards and found in conformity with the CE Council Directive of 89/105/EEC. It is possible to use CE marking to demonstrate the conformity with the CPD Directive.

Report No.: LPTC101203E

Applicant: SHENZHEN SUN GLOBAL GLASS CO., LTD.

Address: NO.34 FLOOR SA RUIJONG BUILDING, BUJIAOYUAN, LONGGANG DISTRICT, SHENZHEN GUANGDONG, CHINA

Manufacturer: SHENZHEN SUN GLOBAL GLASS CO., LTD.

Address: NO.34 FLOOR SA RUIJONG BUILDING, BUJIAOYUAN, LONGGANG DISTRICT, SHENZHEN GUANGDONG, CHINA

Product: TEMPERED GLASS

Model No.: Smart, Smart, Smart, Smart, Smart, Smart

Trade Mark: N/A

Test Standards: EN 12150-2:2004

The relevant test reports show that the product complies with the essential requirements in the above listed standards. The applicant is authorized to use this certificate in connection with the CE Declaration of CPD conformity according to the Directive.

CE Marking

Produkt auf der Verpackung

