

10mm + 12A + 10mm korkea transpacific eristetty lasi toimittaja, 32mm eristetyt lasiyksikkö, kaksinkertaiset lasit.

10mm + 12A + 10mm eristyslasi on valmistettu 10 mm + 10 mm kahdesta lasista, jossa on tilaa, joka on jaettu alumiinikehyksellä, joka on täynnä tehokkaasti nopeutuvaa kuivaa ainetta. Eristetyn lasin reuna on tiivistetty korkean lujuuden omaavilla tiivisteillä. Eristetty lasi tarvitsee kaksi tiivistysainetta, yksi butyylikumitiiviste korkean lämpötilan yläpuolella molemmilla puolilla alumiinikehystä kiinnittymiseen. Toinen on nimeltään silikonitiiviste, joka on eristetty eristetystä lasista ympärillä. Eristetty lasi on korkea tarttuvuus ja tehokas energiansäästö.

Kuinka tunnistaa korkealaatuinen eristetty lasi?

Hyvä eristetty lasi täytetään inertteihin kaasuihin ja kuivaan aineeseen lasin keskellä, ja se näyttää korkealta läpikuultavalta. Eristetyn lasin reuna on joustava ja kun käytät sormeä koskettamalla sitä, se ei voi pudota pois. Päinvastoin, huonot eristetyt lasitiivisteet ovat näyttäviä nauloja tai jauhoja.

Ominaisuudet:

1. Energy säästäminen - eristetyn lasin alhainen lämmönjohtavuus lasin välissä voi vähentää lämmönsiirtoa sisäpuolelta ulkopuolelle. Siksi se voi säästää energiaa 30-50%.
2. Sound eristys suorituskyky - yksi kerros lasia voi vähentää melua 20-22dB. Normaali eristetty lasi voi vähentää melua 29-31: een, kun taas erityinen lasi on 45dB.
3. High transpacific -eristeinen lasi täytetään tarpeeksi kuivausainetta, joka imee tehokkaasti höyryä sisätilaan tai tunkeutuu ulospäin, jotta sisätilan lasi on täysin kuiva ja kaste.

erittely:

Lasin nimi: 10mm + 12A + 10mm kirkas eristetty lasi

Maksimikoko: 3300X12000mm Pienin koko: 180X350mm

Paksuusalue 12mm-19mm (kaksinkertainen lasitus tai kolminkertainen lasitus)

Ilmatila: 6mm, 9mm, 12mm, 16mm, 19mm (1/4 ", 11/32", 1/2 ", 9/16", 19/32 ", 5/8")

Kaasun täyttö: kuiva ilma, argon

Lasikoostumus: läpinäkyvä lasi, sävytetty lasi, karkaistu lasi, Bent karkaistu.

Lasityypit: karkaistu eristetty lasi, low-e -eristetty lasi, ontto lasi, eristyslasi, kaksinkertaiset lasit, heijastava lasi, silkipainettu eristetty lasi, matala rautakeristetty lasi, low-e -eristyslasi, suljettu eristyslasi, lasilasi, eristetty lasi verholle seinään.



sovellus:

Verhoseinän, asuinikkunan, väliseinän jne. Rakentaminen

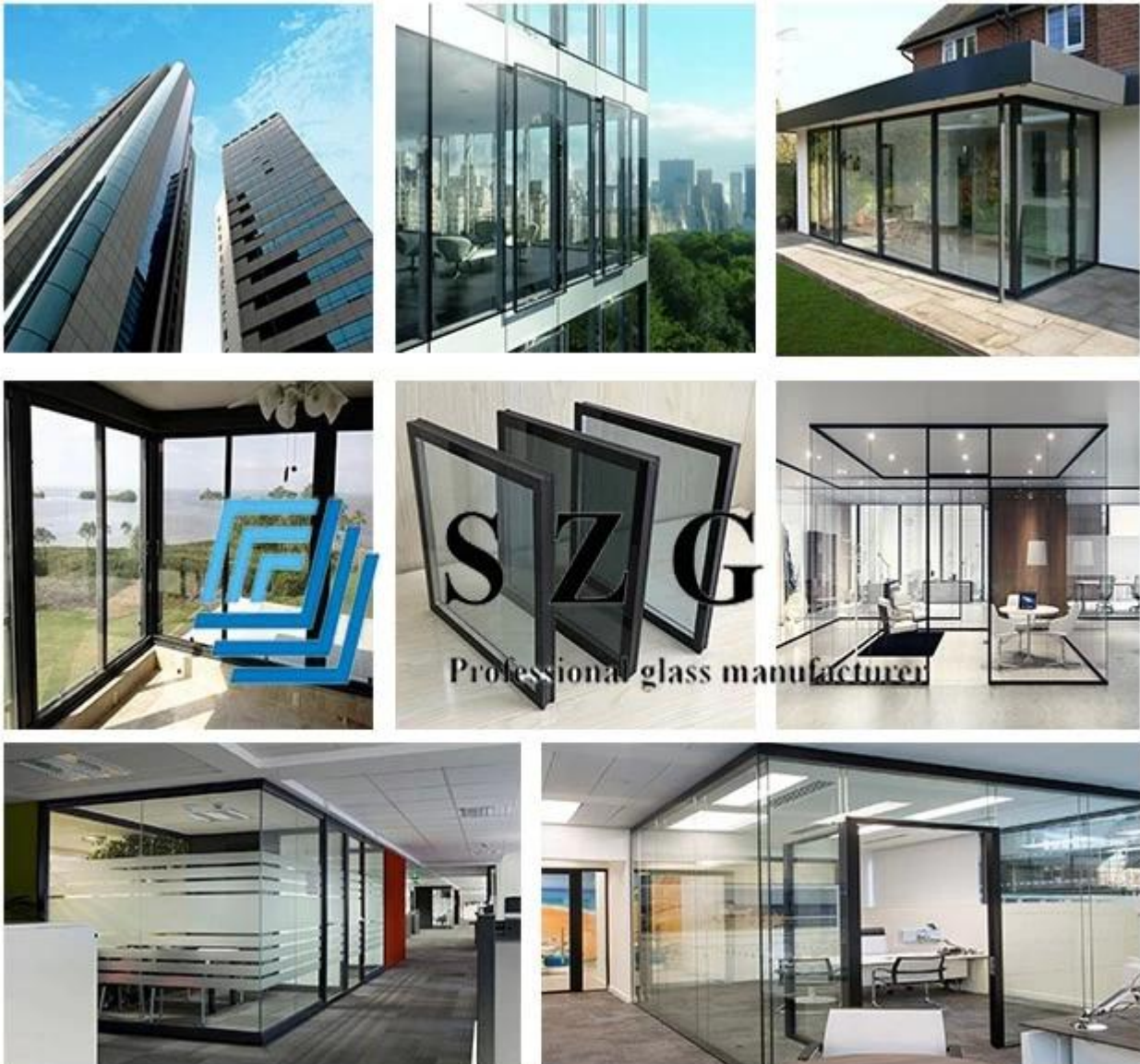

10mm + 12A + 10mm eristyslasi täyttää Euroopan, Pohjois-Amerikan ja Kiinan standardit, ISO, CCC, CE, BS6206, EN12510 jne.

Verification of Conformity
 Evaluation of conformity / Product standard
EN 14449:2005
 The mark is subject to the original test report: 401100110002

The product in the certificate: Laminated Safety Glass, manufactured by SHENZHEN SUN GLOBAL GLASS CO., LTD. was submitted to the manufacturer for Performance Testing according to the dimensional / European standard. The results showed compliance with the applicable requirements. The test results and the content of this certificate of Conformity, including issues in the tested samples. The results remain valid as long as the certificate and data in the above mentioned standard are not modified significantly.

Company Name: SHENZHEN SUN GLOBAL GLASS CO., LTD.
Address: 3F, Qiangyuan Building, Shuangyuan Road, Luoyang, Henan, Zhengzhou, Henan, China

Manufacturer Name: SHENZHEN SUN GLOBAL GLASS CO., LTD.
Address: 3F, Qiangyuan Building, Shuangyuan Road, Luoyang, Henan, Zhengzhou, Henan, China

Product: Laminated Safety Glass
Model: Smart Glass, Privacy Glass, Smart Glass, Privacy Glass, Smart Glass, Privacy Glass and Smart Glass, Privacy Glass

Remarks: Thermally tempered glass is used to make the product.

TS - Producer (Shanghai Co. Ltd):
 No. 111, Lane 111, Road Shanghai Road, Jingji-District, Shanghai 200121, P.R. China

Shanghai, 27 October 2017



Certificate to SPSP100

DuPont Class Laminating Solutions

a glass's certificate to compare:

SHENZHEN SUN GLOBAL GLASS CO., Ltd

has successfully passed the qualification process of DuPont in Nov. 2014

The certificate is valid until the date shown in the below table as long as your manufacturing process for laminated safety glass remains unchanged. Renewal is subject to validation (each supplied laminates).

Date: 2015-2017

SAFED	SAFED	SAFED	SAFED	SAFED	SAFED	SAFED	SAFED
2015	2016	2017	2018	2019	2020	2021	2022

Each sample certificate (this Certificate) is an extension of the certificate in principle. It is not a separate certificate, which is not valid without the original certificate and data in the above mentioned standard are not modified significantly.



DECLARATION OF CONFORMITY

EC Declaration of CPD Conformity

The following product has been tested by Lantest Technology Laboratory Ltd. with the following standards and found in conformity with the EC Council Directive of 89/105/EEC. It is possible to use CE marking to demonstrate the conformity with the CPD Directive.

Report No.: LPTC1012102
Applicant: SHENZHEN SUN GLOBAL GLASS CO., LTD.
Address: NO.34 FLOOR SA RUIJUNING BUILDING, BUJIAOYUAN, LONGHONG DISTRICT, SHENZHEN GUANGDONG, CHINA
Manufacturer: SHENZHEN SUN GLOBAL GLASS CO., LTD.
Address: NO.34 FLOOR SA RUIJUNING BUILDING, BUJIAOYUAN, LONGHONG DISTRICT, SHENZHEN GUANGDONG, CHINA
Product: Insulated Glass
Model No.: Smart-Glass, Smart-Glass, Smart-Glass
Trade Mark: N/A
Test Standards: EN ISO 1278-8

The relevant test report(s) show that the product complies with the essential requirements in the above listed standards. The applicant is authorized to use this certificate in connection with the EC Declaration of CPD conformity according to the Directive.

This certificate of conformity is based on a single evaluation of the submitted samples of the above mentioned product. It does not imply an assessment of the whole production and other relevant Directives have to be observed.

CE 

Shenzhen Sun Global Glass Co., Ltd.
 3F, Qiangyuan Building, Shuangyuan Road, Luoyang, Henan, Zhengzhou, Henan, China

DECLARATION OF CONFORMITY

Professional glass manufacturer

The following product has been tested by Lantest Technology Laboratory Ltd. with the following standards and found in conformity with the EC Council Directive of 89/105/EEC. It is possible to use CE marking to demonstrate the conformity with the CPD Directive.

Report No.: LPTC1012102
Applicant: SHENZHEN SUN GLOBAL GLASS CO., LTD.
Address: NO.34 FLOOR SA RUIJUNING BUILDING, BUJIAOYUAN, LONGHONG DISTRICT, SHENZHEN GUANGDONG, CHINA
Manufacturer: SHENZHEN SUN GLOBAL GLASS CO., LTD.
Address: NO.34 FLOOR SA RUIJUNING BUILDING, BUJIAOYUAN, LONGHONG DISTRICT, SHENZHEN GUANGDONG, CHINA
Product: THERMALLY TEMPERED GLASS
Model No.: Smart, Smart, Smart, Smart, Smart, Smart
Trade Mark: N/A
Test Standards: EN 12150-2:2004

The relevant test report(s) show that the product complies with the essential requirements in the above listed standards. The applicant is authorized to use this certificate in connection with the EC Declaration of CPD conformity according to the Directive.

This certificate of conformity is based on a single evaluation of the submitted samples of the above mentioned product. It does not imply an assessment of the whole production and other relevant Directives have to be observed.

CE 

Shenzhen Sun Global Glass Co., Ltd.
 3F, Qiangyuan Building, Shuangyuan Road, Luoyang, Henan, Zhengzhou, Henan, China

QUALITY MANAGEMENT SYSTEM

CERTIFICATE

Certificate No.: 187100101000000
 No. 1001 (certified)
Shenzhen Sun Global Glass Co., Ltd
 Certified social credit code (Registration code): 914403007101010101
Address: Room 3F, Floor 3, Qiangyuan Building, Luoyang, Henan, Zhengzhou, Henan, China
 In scope of its Quality Management System
 has been awarded this certificate for compliance with the standard
ISO 9001:2015

The Quality Management System applies in the following area:
 Sales of Insulating Glass (IGU) Glass, Tinted Glass, Laminated Glass, Insulated Glass, Mirror Glass and Other Glass Products
 Applicable Clause: 8.5.3

Date of Issue: Nov 09, 2016 Date of Validity: Nov 09, 2019

Nonconformities Audit (1st the first audit)	Nonconformities Audit (2nd the second audit)	Nonconformities Audit (3rd the third audit)

The quality management system is subject to yearly surveillance audits within the period of validity for certificate validity ends when used together with an acceptance notice of full compliance issued by TUV.

Issued by: 

This certificate and its related information can query in the website of Certification and Accreditation Administration of the People's Republic of China (www.cnca.gov.cn)

SHENZHEN SUN GLOBAL INTERNATIONAL CERTIFICATION (SUNIG) Co., Ltd.
 Address: 3/F, Building 3, Shuangyuan Road, Luoyang, Henan, Zhengzhou, Henan, China

DECLARATION OF CONFORMITY

Professional glass manufacturer

The following product has been tested by Lantest Technology Laboratory Ltd. with the following standards and found in conformity with the EC Council Directive of 89/105/EEC. It is possible to use CE marking to demonstrate the conformity with the CPD Directive.

Report No.: LPTC1012102
Applicant: SHENZHEN SUN GLOBAL GLASS CO., LTD.
Address: NO.34 FLOOR SA RUIJUNING BUILDING, BUJIAOYUAN, LONGHONG DISTRICT, SHENZHEN GUANGDONG, CHINA
Manufacturer: SHENZHEN SUN GLOBAL GLASS CO., LTD.
Address: NO.34 FLOOR SA RUIJUNING BUILDING, BUJIAOYUAN, LONGHONG DISTRICT, SHENZHEN GUANGDONG, CHINA
Product: THERMALLY TEMPERED GLASS
Model No.: Smart, Smart, Smart, Smart, Smart, Smart
Trade Mark: N/A
Test Standards: EN 12150-2:2004

The relevant test report(s) show that the product complies with the essential requirements in the above listed standards. The applicant is authorized to use this certificate in connection with the EC Declaration of CPD conformity according to the Directive.

This certificate of conformity is based on a single evaluation of the submitted samples of the above mentioned product. It does not imply an assessment of the whole production and other relevant Directives have to be observed.

CE 

Shenzhen Sun Global Glass Co., Ltd.
 3F, Qiangyuan Building, Shuangyuan Road, Luoyang, Henan, Zhengzhou, Henan, China

tuote pakkauksessa

